

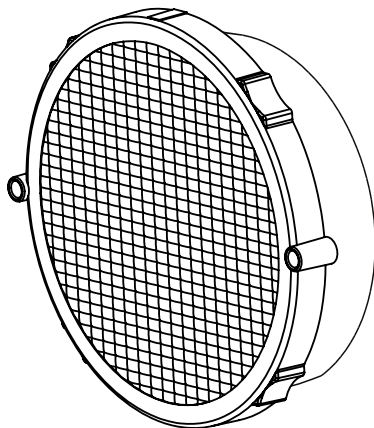

## RS 2000 plus 12 / 24 V



**209291 LED**      LED Advanced Warning Lamp

**214091 LED**      LED Double system

**214091/3LED**      LED Triple system

**214091/4LED**      LED Quadruple system

**BAST-Prüfnr. V3-07-2014**

# horizont

**horizont group gmbh**  
Traffic Safety

Postfach 13 40  
34483 Korbach

Homerger Weg 4-6  
34497 Korbach  
Germany

Telefon: +49 (0) 56 31 / 5 65 - 2 00  
Telefax: +49 (0) 56 31 / 5 65 - 2 48

traffic@horizont.com  
www.horizont.com



## Product specifications

horizont RS 2000 plus advance warning lamp is designed for use as a blinking / flashing light in accordance with EN 12352 class L8H / TL warning lights WL6. The luminous intensity is reduced in darkness in order to avoid dazzling road users.

Power can be supplied by mains connection or rechargeable battery.

By means of the of the fastening bracket SECURA 52 mounted on the back of the housing the lamp can be mounted to posts of different diameters with a maximum diameter of 52 mm / dimensions 52x52 mm. The nuts of the SECURA bracket can be tightened using the SECURA key, included in delivery.

## Intended use

horizont RS 2000 plus advance warning lamp is intended for use on public and non-public roads. It is designed to be used in either combination with other traffic signs or independently as an advance warning of road works or hazardous area.

horizont RS2000 lamps are to be used in accordance with the requirements of the German guidelines for securing road works (RSA) or the inspection schedules.

Any other use is not intended by horizont group gmbh.

## Safety Instructions

The operation of the RS 2000 plus horizontal warning light does not pose any significant risks to the user.

When switched on and the lens is removed, it is important to avoid looking directly at the high-intensity light diodes, as this can cause eye irritation. The same applies to looking directly into the beam of the lamp at short distances of less than 5 metres.

Installation/use in traffic areas must be in accordance with the relevant road traffic regulations and/or accident prevention and industry association regulations for personal protection and road safety.

The product must be installed in such a way that it does not endanger road traffic and/or public safety. In addition, the provisions of the Road Traffic Act regarding the installation of accessories on vehicles (for RS 2000 plus multiple systems) must be observed.

## Operation

Depending on the version, the RS 2000 plus must be connected to the supply voltage > battery terminals. When mounted on a vehicle and connected to the vehicle power supply, a fuse with a rated current of 2 A must be used.

As the device does not come with a switch, the light/ set will start working immediately. Carry out the configuration by means of the DIL switch on the PCB of the (master) lamp (see figure/table on page 4). In the event of a malfunction, the device must be removed from the working area immediately.

## Installation, operating position and maintenance

The horizont RS 2000 plus is installed perpendicular to the road surface (light emission surface). The lamp must be positioned in such a way that the light beam is clearly visible to road users at a reasonable distance, depending on the speed driven.

There are no parts or equipment inside the horizont RS 2000 plus lamp that require maintenance. The optics of the lamp must be cleaned with water and a sponge after use. The use of high pressure cleaners, strong water jets and chemical cleaning agents is not recommended.

The threads of the mounting screws should be greased or oiled occasionally. Pole sleeves or battery terminals must be cleaned as required and protected against corrosion with suitable pole grease.

Repairs should only be carried out by qualified personnel or by the manufacturer.

## Disclaimer

horizont group gmbh accepts no liability for personal injury or damage to property resulting from improper use and/or improper or incorrect installation, assembly, operation or maintenance.

The statutory guarantee and warranty provisions apply.

**Assamby drawing**

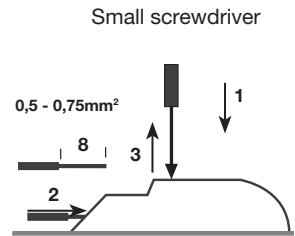
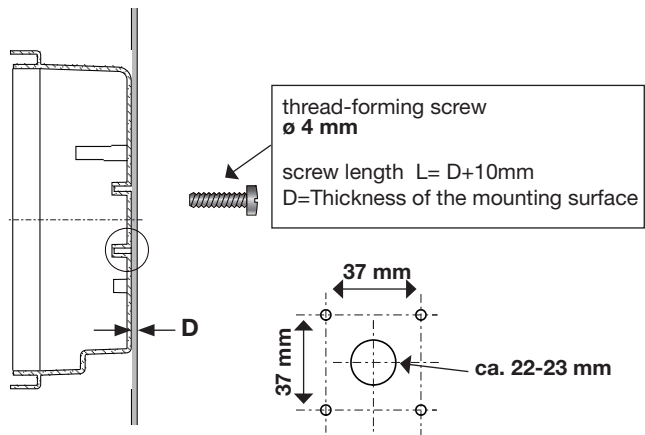

**Connection clamp**

The stripped and twisted stranded wire is inserted into the terminal so far that the insulation reaches the terminal housing

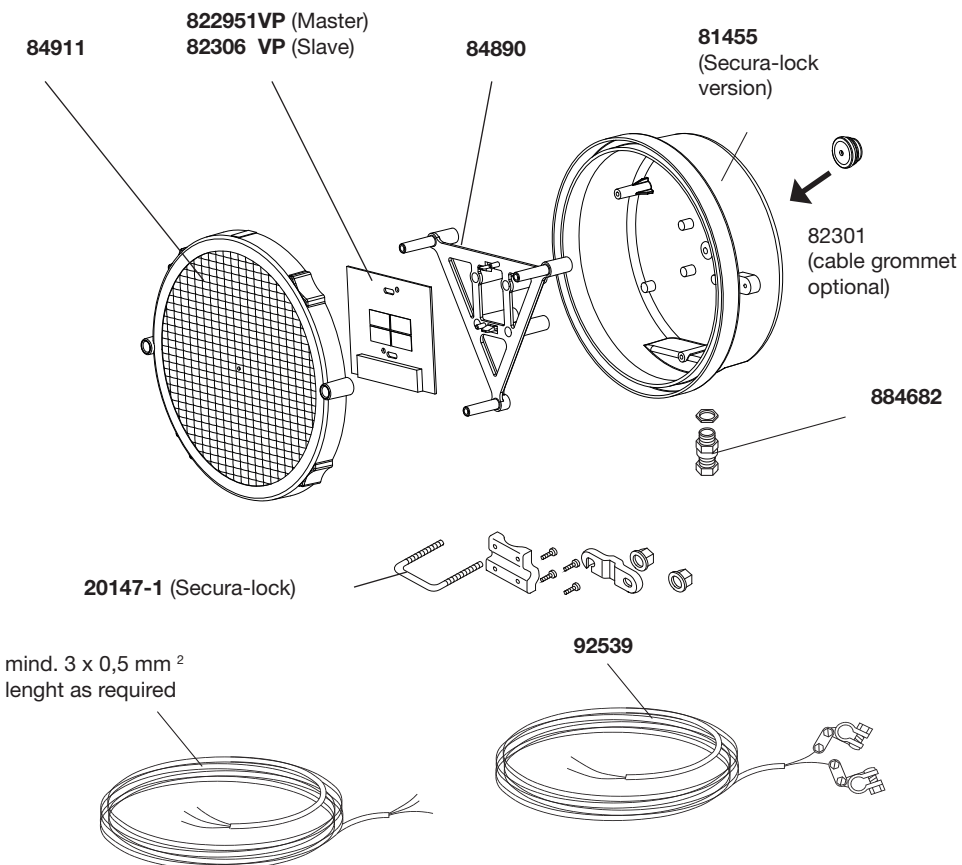

Wiring diagrams

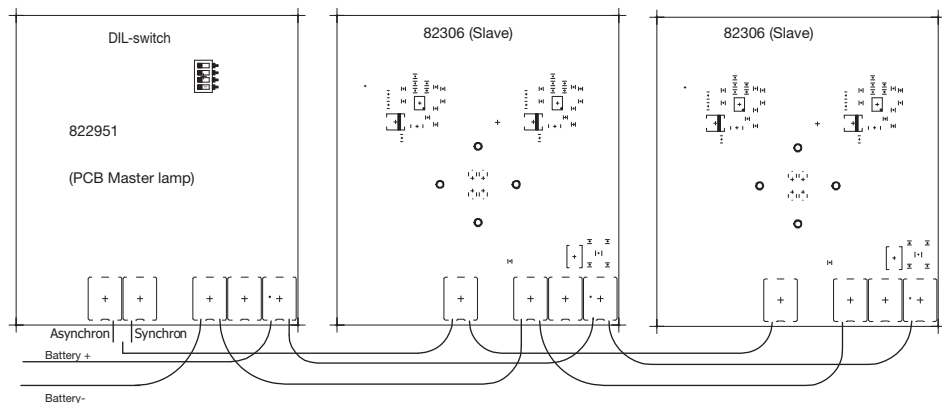

DIL-switch

S1	ON	Deep discharge protection 24V
	OFF	Deep discharge protection 12V
S2	ON	Flashing light
	OFF	Beacon light
S3	ON	Night time dimming OFF
	OFF	Night time dimming ON
S4	ON	Deep discharge protection OFF
	OFF	Deep discharge protection ON

At delivery  
all switches are **OFF** !

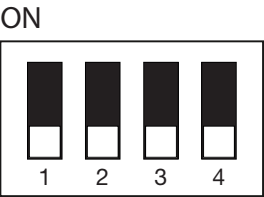

OFF

Technical data

Operation voltage vehicle on-board power	Advanced Warning Lamp 12 / 24 V	Double system 12 / 24 V	Triple system 12 / 24 V	Quadruple system 12 / 24 V
Ø Power consumption				
Day	0,12 A	0,24 A	0,36 A	0,48 A
Night	0,04 A	0,08 A	0,12 A	0,16 A
recommended fuse in car		2 A	2 A	2 A
blinking rate	~ 40 min.	~ 40 min.	~ 40 min.	~ 40 min.
Night time dimming	~ 30%	~ 30%	~ 30%	~ 30%

Technical changes reserved !